

1245 21 JUNE WINTER SOLSTICE

APARTMENTS: 305, 405, 505, 605, 705, 805, 905, 1005, 1105, 1205, 1305

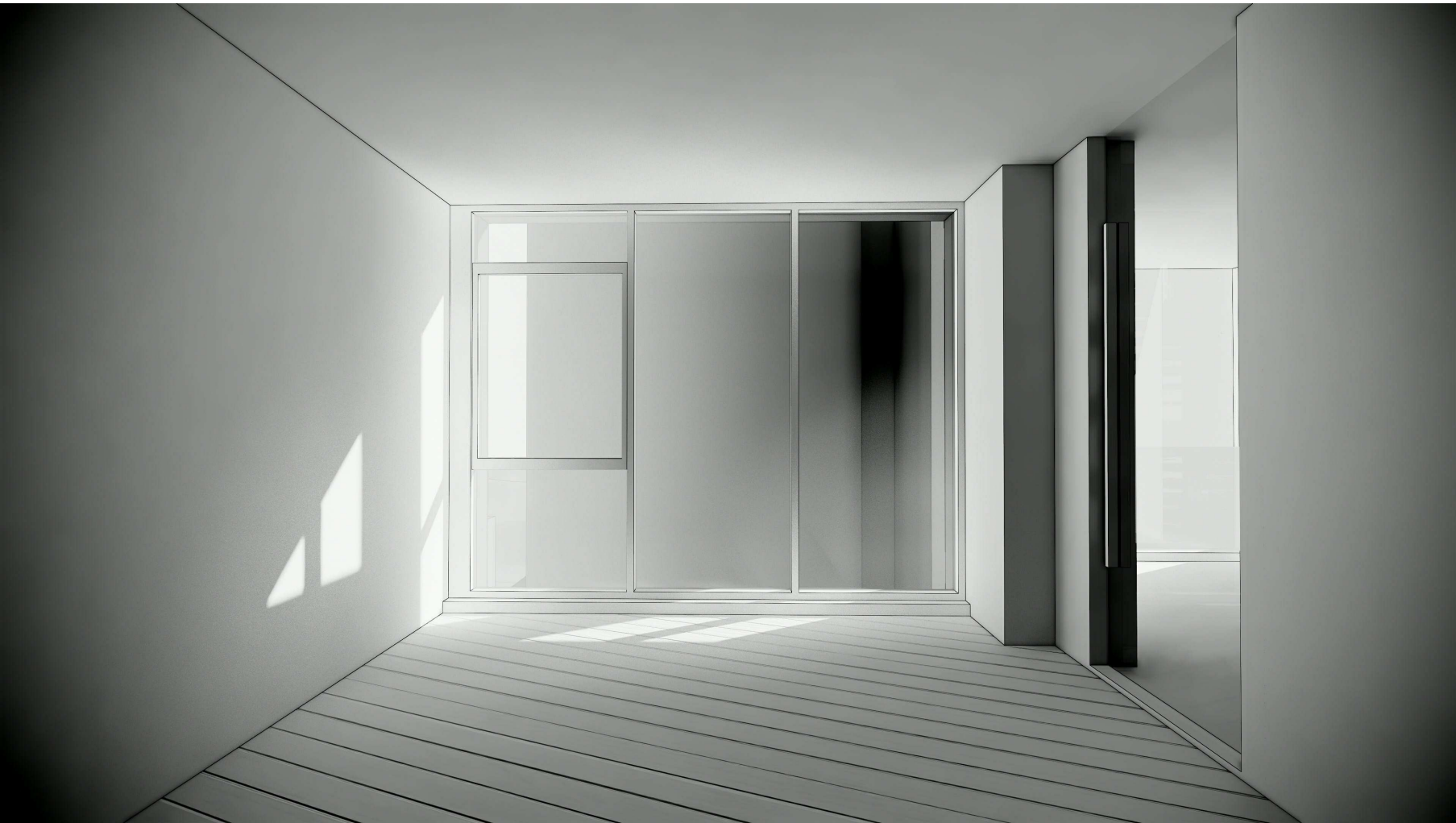

1315 21 JUNE WINTER SOLSTICE

APARTMENTS: 305, 405, 505, 605, 705, 805, 905, 1005, 1105, 1205, 1305



1345 21 JUNE WINTER SOLSTICE

APARTMENTS: 305, 405, 505, 605, 705, 805, 905, 1005, 1105, 1205, 1305



1415 21 JUNE WINTER SOLSTICE

APARTMENTS: 305, 405, 505, 605, 705, 805, 905, 1005, 1105, 1205, 1305



1445 21 JUNE WINTER SOLSTICE

APARTMENTS: 305, 405, 505, 605, 705, 805, 905, 1005, 1105, 1205, 1305

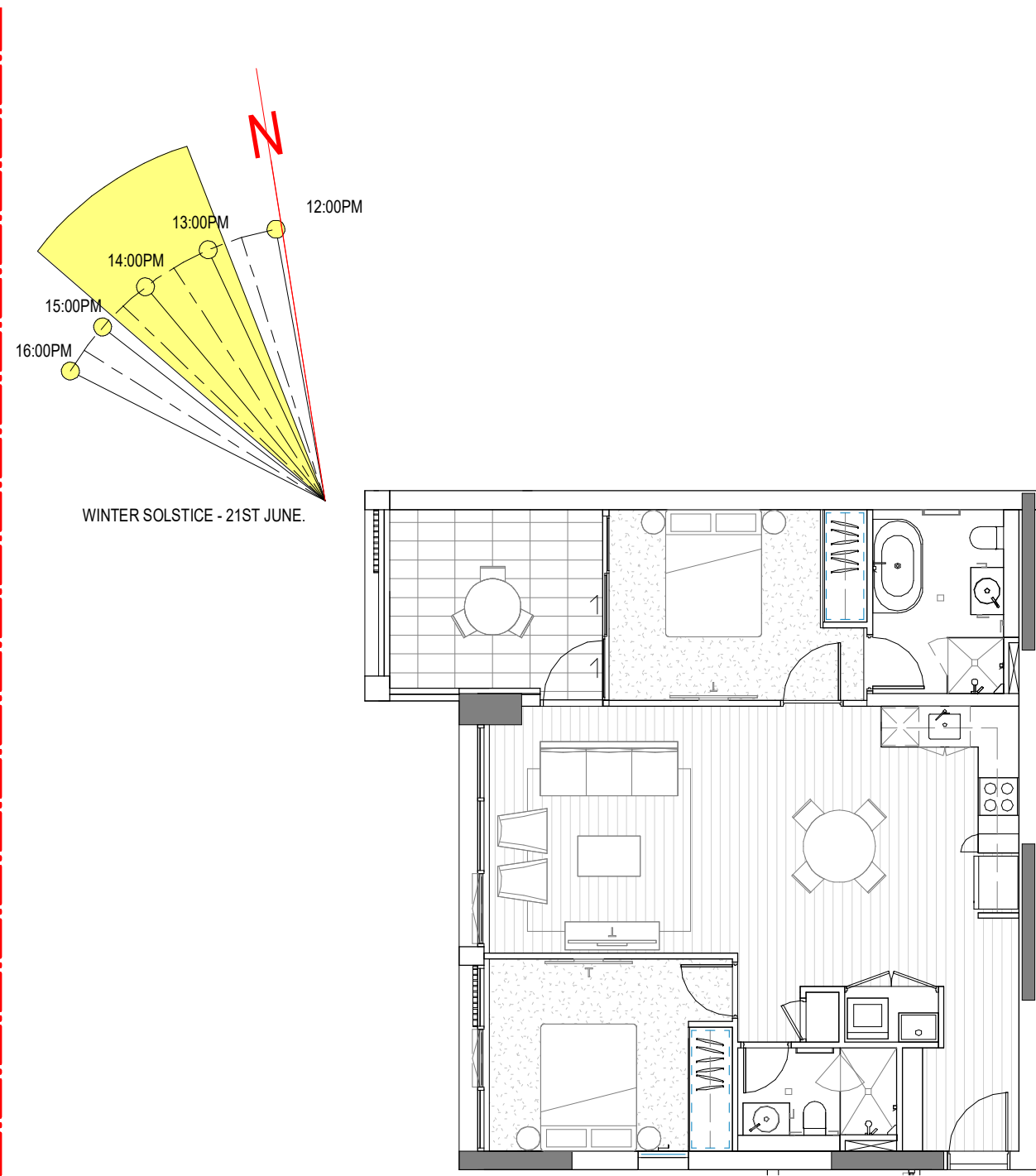

TYPICAL APARTMENT 305-1305

In accepting and utilising this document the recipient agrees that SJB Architecture (NSW) Pty. Ltd. ACN 081 094 724 T/A SJB Architects, retain all common law, statutory law and other rights including copyright and intellectual property rights. The recipient agrees not to use this document for any purpose other than its intended use, to waive all claims against SJB Architects resulting from unauthorised changes, or to reuse the document on other projects without prior written consent from SJB Architects. Under no circumstances shall transfer of this document be deemed a sale. SJB Architects makes no warranties of fitness for any purpose. The Builder/Contractor shall verify job dimensions prior to any work commencing. Use figured dimensions only. Do not scale drawings.
Nominated Architects: Adam Haddow-7188 | John Pradel-7004

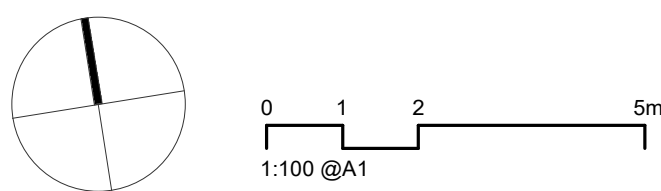

Rev	Date	Revision	By	Chk.
34	2021.06.23	FOR COORDINATION	JG	NH
35	2021.06.24	PLACEHOLDER	JG	NH
37	2021.06.26	DA ISSUE	JG	NH



Project
BATA PAGEWOOD - LOT E

Drawing Name
SOLAR ANALYSIS - APARTMENTS 305-1305

Minor changes to form and configuration may be required when drawings are subsequently prepared for design development and/or construction purposes after the grant of development consent.

Date	Scale	Sheet Size
2021.08.26	1 : 100	@ A1
Drawn	Chk.	Job No.
Author	Checker	6354
Drawing No.	Revision	
DA-3008	/ 37	

SJB Architects
L2, 490 Crown St
Surry Hills NSW
2010 Australia
T 61 2 9380 9911
www.sjb.com.au

